

8 7 6 5 4 3 2 1

NOZZLE SCHEDULE						MAX. PERMISSABLE OPERATING NOZZLE LOADS					
SIDE	REF	O.D.	WALL	DUTY	FLANGE TYPE/RATING	F.rad N	F.long N	F.circ N	M.tor Nm	M.long Nm	M.circ Nm
A	N1	9.52	2.5	HOT INLET	MAXIMATOR	N/A	N/A	N/A	N/A	N/A	N/A
	N2	9.52	2.5	HOT OUTLET	MAXIMATOR	N/A	N/A	N/A	N/A	N/A	N/A
B	N3	28	2	COLD INLET	SWAGELOK	N/A	N/A	N/A	N/A	N/A	N/A
	N4	28	2	COLD OUTLET	SWAGELOK	N/A	N/A	N/A	N/A	N/A	N/A

DESIGN DATA		
	SIDE A	SIDE B
SERVICE	H2	CO2
DESIGN PRESSURE MPaG	100	3
TEST PRESSURE MPaG	143	4.3
DESIGN TEMP. (MAX) °C	80	80
DESIGN TEMP. (MIN) °C	-65	-65
CORROSION ALLOWANCE mm	0	0
CAPACITY L	0.2	0.6
NDT	V/PT	
STRESS RELIEF	NONE	
MASS (DRY) kg	52	
MASS (OPERATING) kg	52	
MASS (FULL OF WATER) kg	53	
DESIGN CODE	ASME VIII Div 1 (2019) PRESSURE EQUIPMENT DIRECTIVE PED CATEGORY:III	
	GROUP 1	GROUP 2

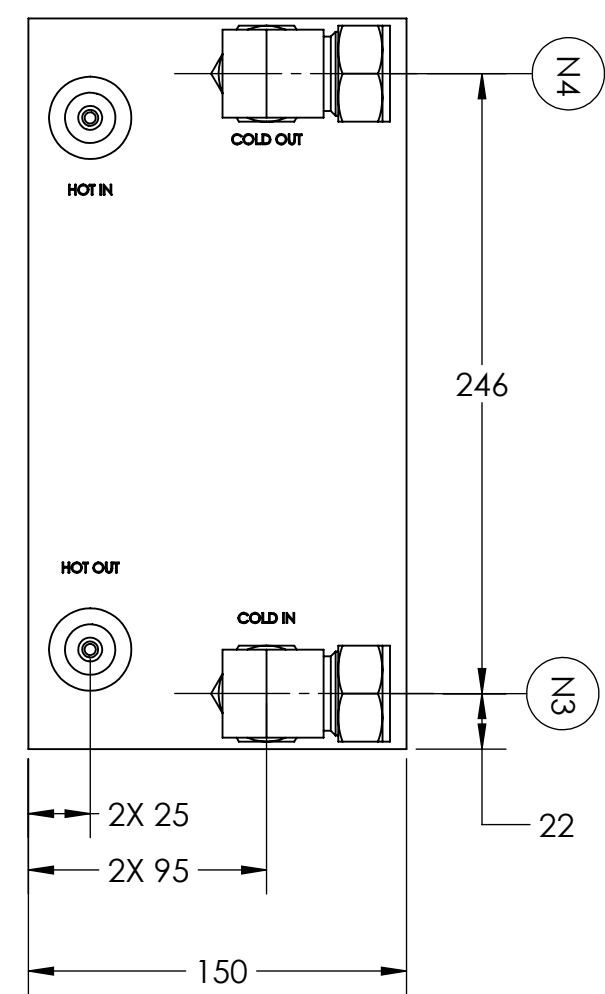
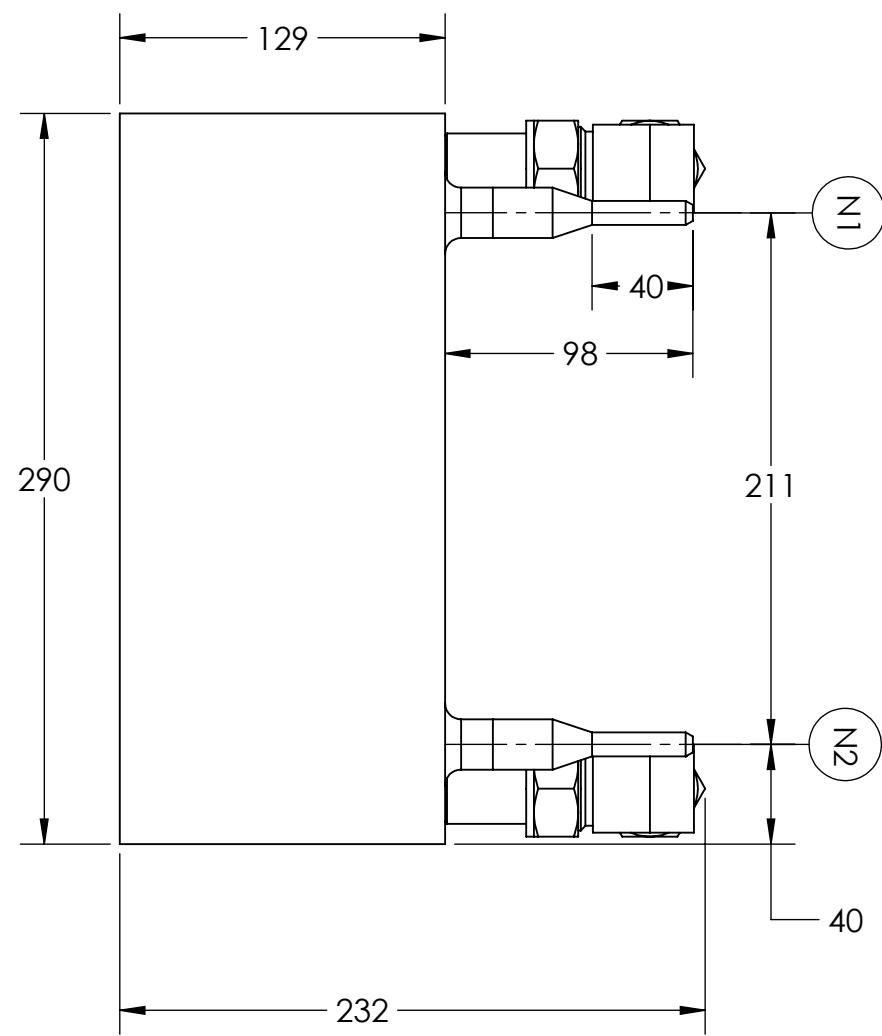

7	CORRECTED 14.3MM TO 9.52MM	12/8/2020
6	CORRECTED CAT IV TO III, ADDED VOLUMES, ADDED PT DESIGNATION TO NDT, REMOVED -03 FROM DWG NO.	10/23/2020
5	CORRECT THE N1 & N2 OD TO 14.3 MM	9/8/2020
4	REDUCED WALL THICKNESS N3 & N4 TO 2MM	7/8/2020
3	REMOVED LIFTING LUGS INCREASED WALL THICKNESS ON N1 & N2 UPDATED DESIGN CODE YEAR	2/19/2020
2	UPDATED DESIGN DATA TABLE	6/11/2019
1	INITIAL ENGINEERING RELEASE	5/30/2019

REV.	REVISIONS	APPR.	DATE	ECO#
	PREPARE BY: RK		DATE: 6/11/2019	
	APPROVED BY:		DATE:	

- NOTES:
- PARTS SHALL HAVE MATERIAL CERTIFICATION IN ACCORDANCE WITH BS EN 10204 3.1.
  - ALL DIMENSIONS ARE IN MILLIMETERS
  - NAMEPLATE TO BE WELDED ONTO UNIT
  - AUSTENITIC STAINLESS STEEL MATERIALS ARE NOT IMPACT TESTED AT THE MINIMUM DESIGN TEMPERATURE AS THESE MATERIALS ARE EXEMPT FROM SUCH TESTING IN ACCORDANCE WITH UHA-51 (d)

**PROPRIETARY AND CONFIDENTIAL**  
 THE INFORMATION CONTAINED IN THIS DRAWING IS THE SOLE PROPERTY OF VACUUM PROCESS ENGINEERING. ANY REPRODUCTION IN PART OR AS A WHOLE WITHOUT THE WRITTEN PERMISSION OF VACUUM PROCESS ENGINEERING IS PROHIBITED.

COMMENTS:  
 UNLESS OTHERWISE SPECIFIED:  
 DIMENSIONS ARE IN MILLIMETERS  
 TOLERANCES:  
 ANGULAR: ± 1°  
 0 > 20: ± 1  
 20 > 400: ± 2  
 500 >: ± 3  
 INTERPRET GEOMETRIC TOLERANCING PER: ASME Y14.5  
 DO NOT SCALE DRAWING

**VPE Vacuum Process Engineering**  
 110 Commerce Circle  
 Sacramento, CA 95815  
 (916)925-6100 Fax: (916)925-6111

JOB NUMBER: TBD HX NUMBER: HX-01130

TITLE: GENERAL ARRANGEMENT

SIZE DWG. NO. REV  
**B** HX-01130 **7**

SCALE: 1:3 WEIGHT: SHEET 1 OF 1

8 7 6 5 4 3 2 1